



MIA Shower/Wall Mixer with Diverter WMH24F92DH



Product information

Don't get lost in the dark! The Mia series' matte black finish gives off an exquisite and sophisticated aura that is bound to perfectly compliment any contemporary designs.

Available finishes:

Matte Black

Specifications:

Product Code: WMH24F92DH Black

Materials: Brass

Temperature: Max 80°C

Pressure: Max 500 Kpa

Connections: 1/2" BSP Female

Warranty:

15 years warranty for parts

5 year warranty for parts and labour

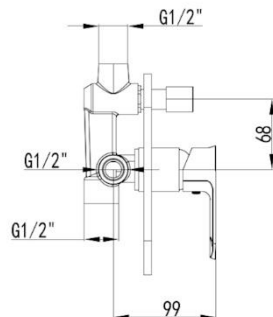
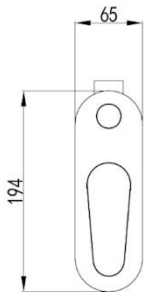

15 SUMMER
YEAR
WARRANTY

